

ONE EXPLANATION DOES NOT FIT XIL

Felix Friedrich^{1,2}, David Steinmann¹, Kristian Kersting^{1,2,3,4}

¹Department of Computer Science, TU Darmstadt; ²Hessian.AI;

³Centre for Cognitive Science, TU Darmstadt; ⁴German Center for Artificial Intelligence (DFKI)

{lastname}@cs.tu-darmstadt.de

ABSTRACT

Current machine learning models produce outstanding results in many areas but, at the same time, suffer from shortcut learning and spurious correlations. To address such flaws, the explanatory interactive machine learning (XIL) framework has been proposed to revise a model by employing user feedback on a model’s explanation. This work sheds light on the explanations used within this framework. In particular, we investigate simultaneous model revision through multiple explanation methods. To this end, we identified that *one explanation does not fit XIL* and propose considering multiple ones when revising models via XIL.

Motivation Nowadays, machine learning models generally suffer from flaws, e.g. model bias (Bianchi et al., 2022; Bender et al., 2021) or confounding behavior (Geirhos et al., 2020; Lapuschkin et al., 2019). Furthermore, they remain opaque and little understood. Therefore, it becomes crucial to make models understandable as their applications get more and more integrated into our lives. As a remedy, explainable artificial intelligence (XAI) has emerged with methods to explain a model, often its outputs, to the user. One step further, several works leverage such explanations in the learning setting, e.g., to improve a model beyond explainability or unconfound it (Teso & Kersting, 2019; Teso et al., 2022; Selvaraju et al., 2019; Friedrich et al., 2022). User interaction plays a central role therein, substantially enhancing recent applications (Ouyang et al., 2022). A promising framework that leverages explanations interactively to improve a model’s performance is XIL (*cf.* Fig. 1). Given a model which provides an explanation (EXPLAIN, Fig. 1) for a decision of a selected example, the user can interact with the model and provide corrective feedback on the explanation.

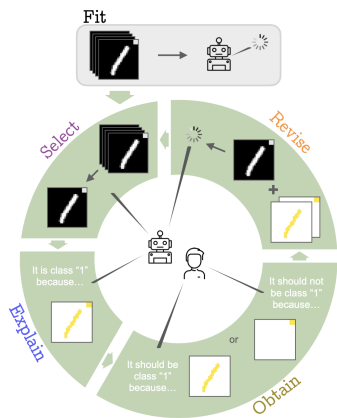

Figure 1: XIL by Friedrich et al. (2022). A model generates explanations (EXPLAIN) and a user provides corrective feedback to revise the model.

This way, the model is not only optimized for the actual task but also revised to align its explanations with the user-provided feedback. However, XIL’s EXPLAIN module has only been realized and investigated for one explainer at a time (e.g., RRR (Ross et al., 2017) uses Input Gradients (IG)). This work transfers the *one explanation does not fit all* paradigm (Arya et al., 2019; Sokol & Flach, 2020) to XIL. In general, each explainer has inherent limitations, e.g., IG (Hechtlinger, 2016) provides only local explanations. In turn, revising a model via XIL implemented with a single explainer does not ensure a model’s revision in its entirety. That means explainers’ different capabilities and limitations translate to XIL methods and impact their effectiveness (Friedrich et al., 2022). Therefore, as a sensible next step, we investigate XIL with combinations of explainers. We show this helps further improve model revision regarding explanation quality. This work motivates designing future methods that leverage explanations of multiple explainers, as no single best explainer exists to be optimized for.

optimizing two objectives at the same time: the prediction ($\mathcal{L}^{\text{pred}}$) and explanation loss (\mathcal{L}^{xil}). The former is the same as in the standard training objective, while the explanation loss additionally constrains the explanations based on user feedback. The combined loss enforces a concurrent optimization of model outputs and explanations. So far, \mathcal{L}^{xil} was only implemented with a single explainer

a) Acc (\uparrow)	train	test	b) WR (\downarrow)	Vanilla	RRR	RRR-G	RBR
w/o decoy	99.8 \pm 0.1	98.8 \pm 0.1	IG	23.1 \pm 3.8	0.0 \pm 0.0	11.9 \pm 2.1	2.0 \pm 1.3
Vanilla	99.9 \pm 0.0	78.9 \pm 1.1	GradCAM	38.7 \pm 4.6	13.3 \pm 2.0	1.5 \pm 0.8	15.2 \pm 3.8
RRR	99.9 \pm 0.1	98.8 \pm 0.1	IntGrad	41.3 \pm 2.2	0.0 \pm 0.0	21.0 \pm 3.4	17.8 \pm 5.4
RRR-G	99.7 \pm 0.2	97.4 \pm 0.7	LIME	59.8 \pm 2.0	32.1 \pm 0.4	33.3 \pm 2.8	37.7 \pm 3.0
RBR	100.0 \pm 0.0	99.1 \pm 0.1					

Table 1: Mean accuracy and WR scores [%] with standard deviation (5 runs) on DecoyMNIST. All XIL methods overcome the confounder in terms of accuracy (a). However, the WR scores (b) show that XIL mainly improves the explanation quality for internally-used explainers. Best values bold.

(EXPLAIN). For example, RRR (Ross et al., 2017) uses IG (Hechtlinger, 2016), RBR (Shao et al., 2021) uses influence functions (IF, Koh & Liang (2017)), while RRR-G (Schramowski et al., 2020) use gradient-weighted class activation maps (GradCAM, Selvaraju et al. (2017)). In contrast to these methods, we realize \mathcal{L}^{xil} with multiple explainers, giving

$$\mathcal{L} = \mathcal{L}^{\text{pred}} + \sum_i \lambda_i \mathcal{L}_i^{\text{xil}}, \quad (1)$$

where λ weights each explanation loss. The modified objective optimizes the model regarding multiple explainers, overcoming the limitations of specific ones.

Results We base our experimental evaluation on the DecoyMNIST dataset—a variation of MNIST with decoy squares in the image corners, confounding the training data. We measure model performance with prediction accuracy and the explanation quality via a wrong reason measure (WR, cf. A.1; lower is better). It examines how wrong a model’s explanation for a specific prediction is, given ground-truth wrong reasons. Further details and results can be found in A.2 and A.3.

Tab. 1a shows that XIL methods independent of the internally-used explainer successfully revise a model in terms of accuracy. However, Tab. 1b demonstrates that the model still relies on wrong reasons when generating explanations with various explainers. For example, applying RRR (employing IG explanations) substantially reduces WR for IG and Integrated Gradients (IntGrad), but GradCAM and LIME (Ribeiro et al., 2016) scores are still high, i.e. have high activations in the confounder area. This highlights that the WR score of the internally-used explainer alone is no suitable indicator for confounding behavior. More importantly, the results show that revising a model with XIL through one explainer does not generalize to (all) different explainers. In contrast, Tab. 2 illustrates that leveraging a combination of various explanations into one XIL method reduces WR among multiple explainers while the accuracy remains on par (Tab. 3). Combining RRR and RRR-G yields low WR scores for all explainers (except LIME, though improved), where single methods struggle with. Moreover, combining RRR and RBR shows that not directly related explainers (GradCAM or LIME) can be improved, too. The final combination again highlights that combining multiple explanations better *fits* XIL, i.e., further improving a model’s explanation quality. However, one can see that combining methods does not set all scores to zero. This questions the reliability and robustness of explainers, an active research area (Adebayo et al., 2018). Hence, more research on explainers is needed. Furthermore, as the rightmost column in Tab. 2 shows (GradCAM score is not lowest), another exciting avenue for future work entails further investigating λ_i to trade off the influence of each explainer. Finally, the increase in computational cost must be kept in mind.

	RRR+RRR-G	RRR+RBR	RRR-G+RBR	RRR+RRR-G+RBR
IG	0.0 \pm 0.0	0.0 \pm 0.0	1.0 \pm 0.1	0.0 \pm 0.0
GradCAM	3.1 \pm 1.7	11.8 \pm 2.9	2.3 \pm 1.5	3.5 \pm 2.5
IntGrad	2.2 \pm 0.1	0.0 \pm 0.0	13.5 \pm 0.1	0.0 \pm 0.0
LIME	29.6 \pm 0.8	31.0 \pm 0.9	33.1 \pm 0.8	27.9 \pm 1.0

Table 2: Mean WR scores [%] with sd (5 runs) on DecoyMNIST. The columns depict combinations of explainers used for XIL. The WR scores of combined methods are lower than for methods based on single explainers (cf. Tab. 1b). Lower is better; best values bold.

Conclusion In this work, we studied XIL’s performance from the perspective of explanation methods. We found that optimizing for a single explanation method *does not fit* XIL. Instead, combining

different explanation methods through simultaneous optimization further improves explanation quality, even beyond the optimized explanation methods. Emphasizing the complexity of faithful and explainable models, our results contribute to this goal and motivate future research.

ACKNOWLEDGEMENTS

The authors thank Raynard Widjaja for preliminary results. This work benefited from the Hessian Ministry of Science and the Arts (HMWK) projects ”The Third Wave of Artificial Intelligence - 3AI” and Hessian.AI as well as from the ICT-48 Network of AI Research Excellence Center “TAILOR” (EU Horizon 2020, GA No 952215).

REFERENCES

- Julius Adebayo, Justin Gilmer, Michael Muelly, Ian Goodfellow, Moritz Hardt, and Been Kim. Sanity checks for saliency maps. In *Proceedings of Advances in Neural Information Processing Systems*, pp. 9505–9515, 2018.
- Vijay Arya, Rachel K. E. Bellamy, Pin-Yu Chen, Amit Dhurandhar, Michael Hind, Samuel C. Hoffman, Stephanie Houde, Q. Vera Liao, Ronny Luss, Aleksandra Mojsilović, Sami Mourad, Pablo Pedemonte, Ramya Raghavendra, John Richards, Prasanna Sattigeri, Karthikeyan Shanmugam, Moninder Singh, Kush R. Varshney, Dennis Wei, and Yunfeng Zhang. One explanation does not fit all: A toolkit and taxonomy of ai explainability techniques, 2019.
- Emily M. Bender, Timnit Gebru, Angelina McMillan-Major, and Shmargaret Shmitchell. On the dangers of stochastic parrots: Can language models be too big? In Madeleine Clare Elish, William Isaac, and Richard S. Zemel (eds.), *Conference on Fairness, Accountability, and Transparency (FAccT)*, pp. 610–623, 2021.
- Federico Bianchi, Pratyusha Kalluri, Esin Durmus, Faisal Ladhak, Myra Cheng, Debora Nozza, Tatsunori Hashimoto, Dan Jurafsky, James Zou, and Aylin Caliskan. Easily accessible text-to-image generation amplifies demographic stereotypes at large scale, 2022.
- Felix Friedrich, Wolfgang Stammer, Patrick Schramowski, and Kristian Kersting. A typology to explore and guide explanatory interactive machine learning, 2022.
- Robert Geirhos, Jörn-Henrik Jacobsen, Claudio Michaelis, Richard Zemel, Wieland Brendel, Matthias Bethge, and Felix A. Wichmann. Shortcut learning in deep neural networks. *Nature Machine Intelligence*, pp. 665–673, 2020.
- Yotam Hechtlinger. Interpretation of prediction models using the input gradient. *Preprint at <https://arxiv.org/abs/1611.07634v1>*, 2016.
- Pang Wei Koh and Percy Liang. Understanding black-box predictions via influence functions. In *Proceedings of the 34th International Conference on Machine Learning - Volume 70*, pp. 1885–1894, 2017.
- Sebastian Lapuschkin, Stephan Wäldchen, Alexander Binder, Grégoire Montavon, Wojciech Samek, and Klaus-Robert Müller. Unmasking clever hans predictors and assessing what machines really learn. *Nature Communications*, 2019.
- Long Ouyang, Jeff Wu, Xu Jiang, Diogo Almeida, Carroll L. Wainwright, Pamela Mishkin, Chong Zhang, Sandhini Agarwal, Katarina Slama, Alex Ray, John Schulman, Jacob Hilton, Fraser Kelton, Luke Miller, Maddie Simens, Amanda Askell, Peter Welinder, Paul Christiano, Jan Leike, and Ryan Lowe. Training language models to follow instructions with human feedback, 2022.
- Marco Tulio Ribeiro, Sameer Singh, and Carlos Guestrin. ”why should i trust you?”: Explaining the predictions of any classifier. In *Proceedings of the 2016 Conference of the North American Chapter of the Association for Computational Linguistics: Demonstrations*, pp. 97–101. Association for Computing Machinery, 2016.
- Laura Rieger, Chandan Singh, William Murdoch, and Bin Yu. Interpretations are useful: penalizing explanations to align neural networks with prior knowledge. In *Proceedings of the International Conference on Machine Learning (ICML)*, pp. 8116–8126, 2020.

- Andrew Slavin Ross, Michael C. Hughes, and Finale Doshi-Velez. Right for the right reasons: Training differentiable models by constraining their explanations. In *Proceedings of the Twenty-Sixth International Joint Conference on Artificial Intelligence (IJCAI)*, pp. 2662–2670, 2017.
- Patrick Schramowski, Wolfgang Stammer, Stefano Teso, Anna Brugger, Franziska Herbert, Xiaoting Shao, Hans-Georg Luigs, Anne-Katrin Mahlein, and Kristian Kersting. Making deep neural networks right for the right scientific reasons by interacting with their explanations. *Nature Machine Intelligence*, 2(8):476–486, August 2020.
- Ramprasaath R. Selvaraju, Abhishek Das, Ramakrishna Vedantam, Michael Cogswell, Devi Parikh, and Dhruv Batra. Grad-cam: Visual explanations from deep networks via gradient-based localization. In *Proceedings of the IEEE International Conference on Computer Vision (ICCV)*, pp. 618–626, 2017.
- Ramprasaath R. Selvaraju, Stefan Lee, Yilin Shen, Hongxia Jin, Dhruv Batra, and Devi Parikh. Taking a hint: Leveraging explanations to make vision and language models more grounded. In *Proceedings of the IEEE/CVF International Conference on Computer Vision (ICCV)*, pp. 2591–2600, 2019.
- Xiaoting Shao, Arseny Skryagin, Patrick Schramowski, Wolfgang Stammer, and Kristian Kersting. Right for better reasons: Training differentiable models by constraining their influence function. In *Proceedings of Thirty-Fifth Conference on Artificial Intelligence (AAAI)*. AAAI, 2021.
- Kacper Sokol and Peter Flach. One explanation does not fit all. *KI - Künstliche Intelligenz*, pp. 235–250, 2020.
- Stefano Teso and Kristian Kersting. Explanatory interactive machine learning. In *Proceedings of the AAAI/ACM Conference on AI, Ethics, and Society (AIES)*, pp. 239–245. Association for Computing Machinery, 2019.
- Stefano Teso, Öznur Alkan, Wolfgang Stammer, and Elizabeth Daly. Leveraging explanations in interactive machine learning: An overview. *CoRR*, abs/2207.14526, 2022.
- Han Xiao, Kashif Rasul, and Roland Vollgraf. Fashion-mnist: a novel image dataset for benchmarking machine learning algorithms. *Preprint at <https://arxiv.org/abs/1708.07747>*, 2017.
- Yu Zhong and Gil Ettinger. Enlightening deep neural networks with knowledge of confounding factors. In *Proceedings of the IEEE International Conference on Computer Vision Workshops (ICCVW)*, pp. 1077–1086, 2017.

A APPENDIX

We publish our code with the camera-ready version.

A.1 WR MEASURE

Models revised with XIL are often evaluated based on their accuracy. However, assessing the accuracy does not cover explanation quality, and is not sufficient to capture the effect of XIL. Therefore, we also use the WR measure proposed in Friedrich et al. (2022). For an input X , the WR score measures the percentage of activated pixels from a model explanation ($expl(X)$) compared to a user annotation mask M . In this work, the metric compares how much the model explanation relies on wrong reasons, i.e. activates pixels in the confounder area which represents features of shortcut learning/ spurious correlation.

$$WR(X, M) = \frac{sum(b_{\alpha}(norm^{+}(expl(X))) \circ M)}{sum(M)}, \quad (2)$$

In this equation, \circ is the Hadamard product. $norm^{+}$ normalizes the explanation of explainer $expl$ to $[0, 1]$, while only accounting for positive values. The normalized explanation is then binarized by b_{α} , with α as threshold ($expl_{ij} > \alpha \Rightarrow 1$ else 0).

A.2 EXPERIMENTAL PROTOCOL

Our focus is on evaluating computer vision datasets, which are an active area of research due to their well-known confounders (Zhong & Ettinger, 2017). In these datasets, confounders are visual regions in images (e.g. colored corners) that correlate with image class but are not causal factors for determining the true class. Confounders can deceive the model and lead to shortcut learning rules. In our standard setup, we train machine learning models on a confounded train set and test them on a non-confounded test set with the goal of guiding the model to ignore the confounder. To assess different facets of XIL, we chose two benchmark datasets: Decoy(F)MNIST. These datasets have visually separable confounders that provide a controlled environment for evaluation.

Our experiments use a CNN with two convolution layers (channels=[20,50], kernel size=5, stride=1, pad=0), each followed by a ReLU activation and max-pooling layer. The last two layers are fully-connected. We optimize our models using Adam and a learning rate of 0.001 for 50 epochs. For the standard experiments, we apply the explanation loss from the beginning. We use the standard train-test split (60000 to 10000) and set the batch size to 256.

The DecoyMNIST dataset (Ross et al., 2017) is a modified version of the MNIST dataset that introduces decoy squares into the train set. These 4×4 gray squares appear in randomly chosen corners and their shades are functions of their digits. The gray-scale corners and colors are randomized in the test set. Binary feedback masks M mark confounders for the penalty strategy, while the masks mark the digits (relevant region) for the reward strategy. FashionMNIST (FMNIST) (Xiao et al., 2017) is an updated version of MNIST that is more complex and less overused in research. FMNIST contains images from ten different fashion article classes. The DecoyFMNIST dataset also introduces confounding squares in the same manner as DecoyMNIST.

A.3 FURTHER EXPERIMENTAL RESULTS

Here, we present further results. We evaluated our method on the DecoyMNIST and DecoyFMNIST datasets. We based our experimental evaluation on the work of Friedrich et al. (2022) and more details can be found there. We used the XIL methods RRR, RRR-G, RBR, CDEP (Rieger et al., 2020), HINT (Selvaraju et al., 2019) and counterexamples (CE (Teso & Kersting, 2019)). Notably, HINT does utilize a different feedback revision strategy (REVISE, cf. Fig. 1) than the other methods, as it encourages the model to attend to the regions of the user feedback. CE utilizes dataset augmentation and does not apply a different loss to the model, and instead adds corrected examples to the training dataset.

First, we report the accuracy of the vanilla model, models revised with single XIL methods, and models revised with a combination of XIL methods in Tab. 3. In terms of accuracy, applying XIL

XIL	DecoyMNIST		DecoyFMNIST	
	train	test	train	test
Vanilla	99.9	78.9	99.5	58.3
w/o decoy	99.8	98.8	98.7	89.1
RRR	99.9	98.8	98.7	89.4
RRR-G	99.7	97.4	90.2	78.6
RBR	100.0	99.1	96.6	87.6
CDEP	99.3	97.1	89.8	76.7
HINT	97.6	96.6	99.0	58.2
CE	99.9	98.9	99.1	87.7
RRR + RBR + RRR-G	98.8	98.3	92.0	88.4
RRR + RRR-G	99.2	98.1	91.7	86.9
RRR + RBR	99.9	98.9	98.5	89.5
RRR + CDEP	99.3	98.5	98.2	88.4
RBR + CDEP	99.2	98.6	87.0	87.0
RRR-G + CDEP	98.0	96.6	86.3	81.2
RRR-G + HINT	93.2	94.6	89.6	77.3
CDEP + HINT	97.7	97.4	89.8	75.9
RRR + HINT	93.4	94.4	93.4	89.4
RBR + HINT	95.0	95.4	94.5	84.9
RRR + CE	99.9	98.8	99.2	89.3
RBR + CE	100.0	99.1	94.0	85.2
RRR-G + CE	97.7	96.7	94.6	86.4
CDEP + CE	99.7	98.4	94.1	86.1
HINT + CE	98.4	97.4	93.0	87.3

Table 3: Mean accuracy scores [%] of XIL methods and combinations (5 runs) for Decoy(F)MNIST. The first part shows the accuracy of the confounded Vanilla model, a model on non-confounded data followed by single XIL methods. The next parts show combinations of XIL methods that combine different internally-used explainers. The fifth part presents results for combinations of XIL simultaneously utilizing penalty and reward feedback. The last part shows combinations of XIL using loss and dataset augmentation. Best results bold; higher is better

with multiple explainers provides is on par with single methods, as the accuracy among all categories remains comparable on a high level, overcoming the confounder influence. The accuracy without decoy can be seen as an upper bound, for what the architecture is able to achieve in the best case, i.e. without confounding factors.

The WR scores for single XIL methods in Tab. 4 show that the XIL methods mainly improve WR scores for the internally-used explainer. Additionally, one can observe that HINT alone does not improve the WR scores.

When combining XIL methods with different explainers (Tabs. 5 and 6), one can observe that the WR scores are low for the internally optimized explainers, but they also improve for the other explanation methods. Tab. 7 depicts that the combination of different reward strategies can be beneficial as well. Especially noteworthy is the combination of RRR-G and HINT, which utilizes the same internal explainer, but the different feedback strategies provide substantial improvements over the other individual methods. Lastly, the combination of loss-based XIL methods with dataset augmentation strategies (Tab. 8) does not show a clear tendency. While it substantially improves the explanation quality for, e.g., the combination of RRR-G and CE, it does not for the combination of RRR and CE. Here, we motivate again further research in this direction.

	Vanilla	RRR	RRR-G	RBR	CDEP	HINT	CE
IG	23.1 ± 3.8	0.0 ± 0.0	11.9 ± 2.1	2.0 ± 1.3	15.0 ± 1.5	21.9 ± 3.1	7.3 ± 1.4
GradCAM	38.7 ± 4.6	13.3 ± 2.0	1.5 ± 0.8	15.2 ± 3.8	27.8 ± 3.8	46.8 ± 1.1	14.7 ± 2.9
IntGrad	41.3 ± 2.2	0.0 ± 0.0	21.0 ± 3.4	17.8 ± 5.4	6.8 ± 2.7	40.3 ± 2.5	19.0 ± 1.4
LIME	59.8 ± 2.0	32.1 ± 0.4	33.3 ± 2.8	37.7 ± 3.0	37.9 ± 3.7	53.8 ± 2.0	36.9 ± 0.6

(a) DecoyMNIST

	Vanilla	RRR	RRR-G	RBR	CDEP	HINT	CE
IG	25.0 ± 1.9	0.0 ± 0.0	2.1 ± 0.4	6.0 ± 1.4	15.9 ± 4.5	29.4 ± 3.3	8.1 ± 0.4
GradCAM	34.8 ± 1.4	24.2 ± 4.1	4.6 ± 0.9	16.0 ± 4.8	39.1 ± 1.7	27.8 ± 2.9	24.4 ± 0.9
IntGrad	38.9 ± 2.5	0.0 ± 0.0	28.8 ± 1.9	19.6 ± 5.1	12.5 ± 4.9	38.3 ± 1.0	20.8 ± 1.7
LIME	57.6 ± 0.8	27.4 ± 0.7	38.1 ± 4.5	34.9 ± 1.4	40.2 ± 6.5	51.4 ± 3.5	31.1 ± 0.6

(b) DecoyFMNIST

Table 4: Mean WR scores [%] and standard deviations (5 runs) on Decoy(F)MNIST. The WR scores show that XIL mainly improves the explanation quality for internally-used explainers. The scores remain high for other explainers. Best values bold; lower is better.

	RRR+RRR-G	RRR+RBR	RRR-G+RBR	RRR+RRR-G+RBR
IG	0.0 ± 0.0	0.0 ± 0.0	0.9 ± 0.5	0.0 ± 0.0
GradCAM	2.7 ± 2.1	21.2 ± 2.7	2.5 ± 1.2	2.3 ± 0.4
IntGrad	0.0 ± 0.0	0.0 ± 0.0	16.2 ± 0.6	0.0 ± 0.0
LIME	27.7 ± 1.8	27.1 ± 0.5	30.9 ± 1.1	25.6 ± 0.8

Table 5: Mean WR scores [%] and standard deviations (5 runs) on DecoyFMNIST. The columns depict combinations of explainers used for XIL. The WR scores of combined methods are lower than for methods based on single explainers (*cf.* Tab. 4b). Best values bold; lower is better.

	RRR+CDEP	RBR+CDEP	RRR-G+CDEP
IG	0.0 ± 0.0	2.1 ± 0.9	4.9 ± 2.1
GradCAM	18.5 ± 4.3	19.6 ± 5.1	2.1 ± 1.0
IntGrad	0.2 ± 0.1	6.5 ± 0.9	11.0 ± 4.4
LIME	29.2 ± 0.7	30.8 ± 1.8	33.1 ± 3.9

(a) DecoyMNIST

	RRR+CDEP	RBR+CDEP	RRR-G+CDEP
IG	0.3 ± 0.2	1.9 ± 0.6	7.5 ± 1.3
GradCAM	25.4 ± 2.1	35.4 ± 2.8	3.3 ± 0.5
IntGrad	1.1 ± 0.2	2.9 ± 0.8	6.0 ± 3.5
LIME	28.8 ± 1.0	26.3 ± 0.8	31.3 ± 2.5

(b) DecoyFMNIST

Table 6: Mean WR scores [%] and standard deviations (5 runs) on Decoy(F)MNIST for combinations of XIL methods with different internally-used explainers. One can observe that the scores are lower for combined methods compared to using single methods only. Best values bold; lower is better.

	RRR-G+HINT	CDEP+HINT	RRR+HINT	RBR+HINT
IG	1.0 ± 0.5	0.3 ± 0.1	0.0 ± 0.0	0.8 ± 0.4
GradCAM	3.0 ± 0.3	3.2 ± 0.2	5.3 ± 1.0	3.9 ± 1.0
IntGrad	8.5 ± 0.8	5.6 ± 2.8	1.4 ± 1.0	8.5 ± 1.4
LIME	30.1 ± 5.3	31.0 ± 0.5	27.4 ± 1.2	27.3 ± 0.9

(a) DecoyMNIST

	RRR-G+HINT	CDEP+HINT	RRR+HINT	RBR+HINT
IG	5.2 ± 1.6	15.4 ± 4.0	0.0 ± 0.0	1.2 ± 0.1
GradCAM	2.0 ± 0.6	12.8 ± 1.5	3.6 ± 0.4	4.2 ± 1.1
IntGrad	26.5 ± 3.4	14.3 ± 5.2	0.3 ± 0.2	16.6 ± 2.8
LIME	38.5 ± 3.8	38.3 ± 4.0	22.6 ± 0.6	30.4 ± 0.9

(b) DecoyFMNIST

Table 7: Mean WR scores [%] and standard deviations (5 runs) on Decoy(F)MNIST for combinations of XIL methods with different reinforcement strategies. Here, the penalty (RRR-G, CDEP, RRR, RBR) and reward strategy (HINT) are combined. One can observe that the scores are lower for combined methods compared to using single methods only. The first combination (RRR-G and HINT) is of special interest, as it uses the same explainer internally, but improves the non-internally used scores as well. Best values bold; lower is better.

	RRR+CE	RBR+CE	RRR-G+CE	CDEP+CE	HINT+CE
IG	0.0 ± 0.0	3.5 ± 1.8	3.2 ± 0.4	6.6 ± 1.5	0.9 ± 0.3
GradCAM	11.7 ± 1.3	14.8 ± 1.9	3.2 ± 1.0	1.8 ± 2.5	5.8 ± 0.7
IntGrad	0.0 ± 0.0	9.1 ± 7.5	16.9 ± 7.4	10.2 ± 1.4	14.8 ± 0.8
LIME	29.6 ± 1.3	29.9 ± 5.2	30.2 ± 0.5	31.2 ± 2.1	27.3 ± 0.5

(a) DecoyMNIST

	RRR+CE	RBR+CE	RRR-G+CE	CDEP+CE	HINT+CE
IG	0.0 ± 0.0	5.9 ± 1.0	1.0 ± 0.3	5.9 ± 0.7	0.1 ± 0.0
GradCAM	21.9 ± 2.7	24.8 ± 3.8	4.4 ± 1.0	20.2 ± 6.9	7.5 ± 1.6
IntGrad	0.1 ± 0.0	21.3 ± 3.0	27.6 ± 1.1	18.7 ± 3.7	22.9 ± 2.5
LIME	28.6 ± 0.6	31.7 ± 1.2	32.8 ± 1.3	32.0 ± 1.2	28.1 ± 0.7

(b) DecoyFMNIST

Table 8: Mean WR scores [%] and standard deviations (5 runs) on Decoy(F)MNIST for combinations of XIL methods with different revision strategies. Here, the loss (RRR, CDEP, RRR-G, RBR, HINT) and dataset augmentation strategy (CE) are combined. One can observe that the scores do not significantly improve when combining both strategies. Best values bold; lower is better.